

Amendments

Ashfield-Colborne-Wawanosh

Key Map 10
Ashfield Ward -
Lakeshore

REVISION DATE February 1, 2008

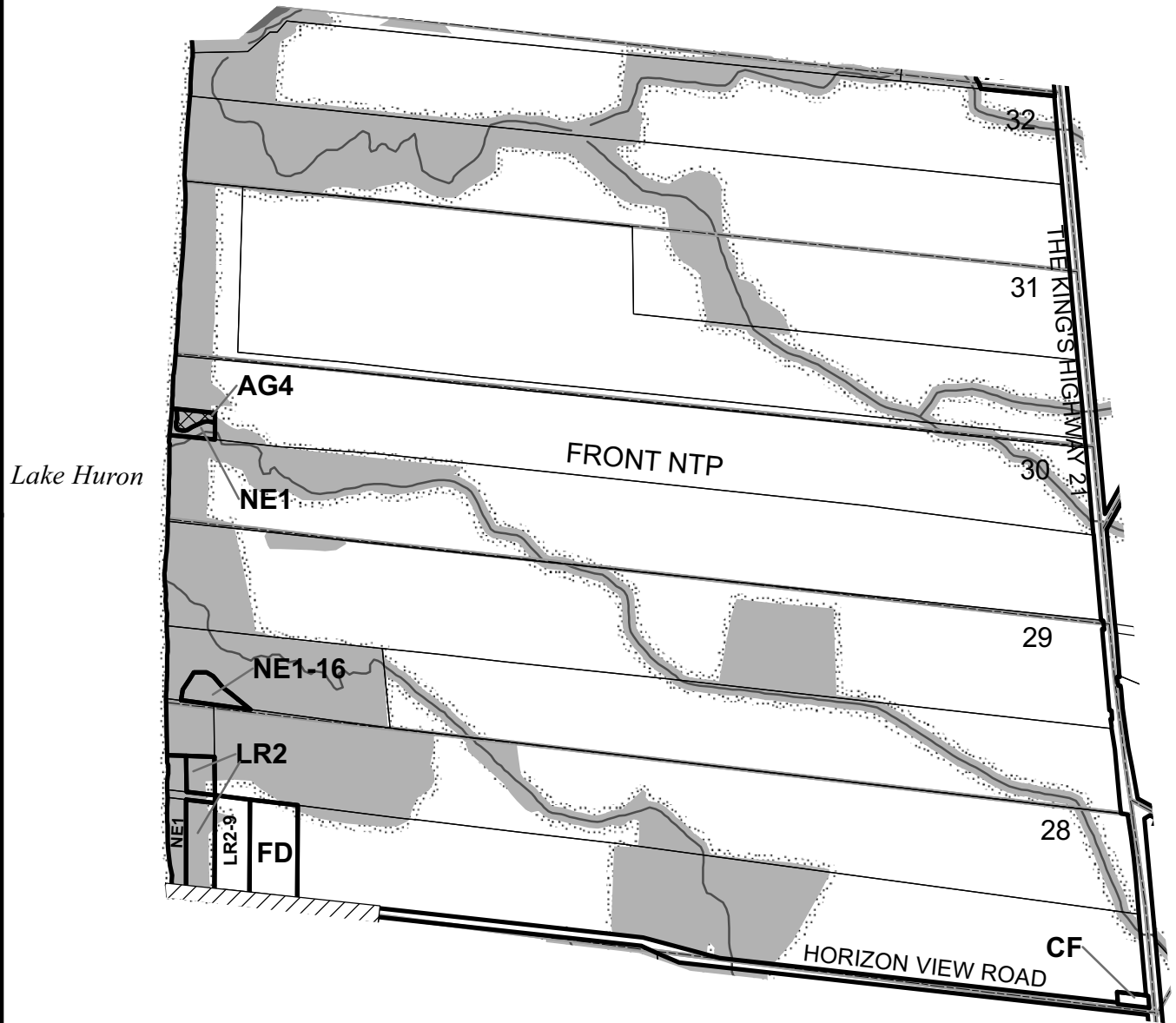

| | | |
|--------------------------|--|----------------------|
| NE5 | Lot Boundaries | Roads |
| NE1 | Property Boundaries | Rivers / Waterbodies |
| AG1-h (See Section 4.11) | Zone (AG1 unless otherwise noted) | Open Landfill |
| Holding Zone | Conservation Authority Regulated Lands | Closed Landfill |
| | | 500m Landfill Buffer |



1:15,000

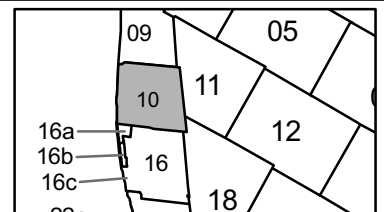
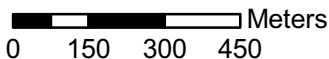

NOTE: Where zone label appears over NE1 or NE5 shading, zone label denotes applicable zone.